

SEA&LAND ELECTRONIC CORP.

13F.,No.120-10,
Sec.3,Zhongshan Rd.,Zhonghe City,Taipei County,
Taiwan, R.O.C.

Tel.: 886-2-8221-2567
Fax.: 886-2-2225-7268

Techfuse
PTC Devices
Resettable Fuse

PRODUCT: MHD420

DOCUMENT: QR0429

ECN. NO.:

REV LETTER:

REV DATE: 2010/7/1

PAGE NO.: 1 of 1

Specification Sheet

Insulating Material:
meets UL94 V-0 Requirements
Lead-free, meets RoHS

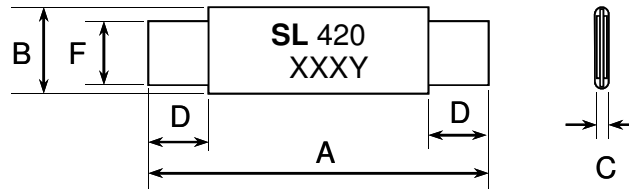

Lead Material: Nickel
0.11mm nominal thickness

Marking:

— Sea & Land Logo
SL 420 - Part identification
XXX - Lot identification

TABLE I. DIMENSIONS:

| | A | | B | | C | | D | | F | |
|----|------|------|------|------|------|------|------|------|------|------|
| | MIN | MAX | MIN | MAX | MIN | MAX | MIN | MAX | MIN | MAX |
| mm | 30.6 | 32.4 | 12.9 | 13.6 | 0.6 | 1.0 | 5.0 | 7.5 | 6.0 | 6.7 |
| in | 1.20 | 1.28 | 0.51 | 0.54 | 0.02 | 0.04 | 0.20 | 0.30 | 0.24 | 0.26 |

TABLE II. PERFORMANCE RATINGS:

| Model | V_{max} (Vdc) | I_{max} (A) | I_{hold} @25°C (A) | I_{trip} @25°C (A) | P_d Typ. (W) | Maximum Time To Trip | | Resistance | | |
|--------|--------------------|------------------|----------------------------|----------------------------|----------------------|-------------------------|---------------|----------------------|----------------------|----------------------|
| | | | | | | Current (A) | Time (Sec) | $R_{i_{min}}$ (Ω) | $R_{i_{max}}$ (Ω) | $R_{1_{max}}$ (Ω) |
| MHD420 | 24 | 100 | 4.20 | 7.6 | 2.9 | 20.00 | 6.0 | 0.012 | 0.024 | 0.040 |

Ordering Information

Packing

| MHD | 420 | Bag Q'ty |
|--------------|--|----------------------------|
| Product name | Hold Current (A) S= Single slitted lead Blank = Standard | MHD420 500 pieces / bag |

Recognition: UL / TÜV , approved.



E201504/E319079 R-50004425