

SEA&LAND ELECTRONIC CORP.

13F.,No.120-10,
 Sec.3,Zhongshan Rd.,Zhonghe City,Taipei County,
 Taiwan, R.O.C.
 Tel.: 886-2-8221-2567
 Fax.: 886-2-2225-7268

Techfuse
PTC Devices
 Resettable Fuse

PRODUCT: HPD260(S)
 DOCUMENT: QR0429
 ECN. NO.:
 REV LETTER:
 REV DATE: 2010/7/1
 PAGE NO.: 1 of 1

Specification Sheet

Insulating Material:
 meets UL94 V-0 Requirements
 Lead-free, meets RoHS

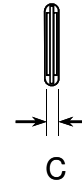
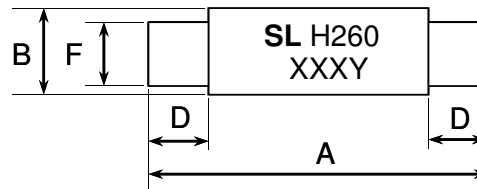

Lead Material:
 Nickel
 0.11mm nominal thickness

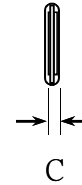
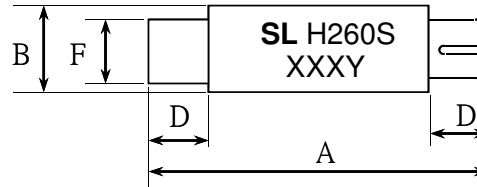

Marking:
 ┌───┐ Sea & Land Logo
SL H260 - Part identification
 XXXY - Lot identification

TABLE I. DIMENSIONS:

	A		B		C		D		F	
	MIN	MAX	MIN	MAX	MIN	MAX	MIN	MAX	MIN	MAX
mm	20.9	23.1	4.9	5.5	0.6	1.0	4.1	5.5	3.9	4.1
in	0.82	0.91	0.19	0.22	0.02	0.04	0.16	0.22	0.15	0.16

TABLE II. PERFORMANCE RATINGS:

Model	V _{max} (Vdc)	I _{max} (A)	I _{hold} @25°C (A)	I _{trip} @25°C (A)	P _d Typ. (W)	Maximum Time To Trip		Resistance		
						Current (A)	Time (Sec)	R _{i_min} (Ω)	R _{i_max} (Ω)	R _{1_max} (Ω)
HPD260(S)	15	100	2.60	5.8	2.5	13.00	5.0	0.020	0.042	0.063

Ordering Information

Packing

HPD	450	S	Bag Q'ty
Product name	Hold Current (A)	S= Single slitted lead Blank = Standard	HPD260(S) 500 pieces / bag

Recognition: UL / TÜV , approved.



E201504/E319079 R-50004425