

SEA&LAND ELECTRONIC CORP.

13F.,No.120-10,
 Sec.3,Zhongshan Rd.,Zhonghe City,Taipei County,
 Taiwan, R.O.C.
 Tel.: 886-2-8221-2567
 Fax.: 886-2-2225-7268

Techfuse
PTC Devices
 Resettable Fuse

PRODUCT: C250-1000
 DOCUMENT: QR0429
 ECN. NO.:
 REV LETTER:
 REV DATE: 2015/11/10
 PAGE NO.: 1 of 1

Specification Sheet

Max Interrupt Voltage: 250 Vac
 Max Operating Voltage: 60 Vdc
 Maximum Interrupt Current: 10 A

Insulating Material:
 meets UL94 V-0 Requirements

Lead-free, RoHS compliant

Lead Material:
 Tin plated copper, 0.8 Dia.

Marking:

┌─── Sea&Land Logo

⌞

C250 - Vmax 250V

1000 - hold current

XXX - Date code

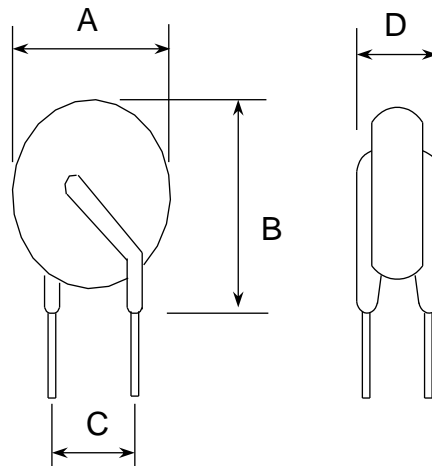

TABLE I. DIMENSIONS:

	A	B	C	D
	MAX	MAX	TYP	Max
mm	20.0	23.0	10.2	4.6

TABLE II. PERFORMANCE RATINGS:

Model	V _{max} (Vac)	I _{max} (A)	I _{hold} @25°C (A)	Maximum Time To Trip		Resistance	
				Current	Time	Ri min	Ri max
				(A)	(Sec)	(Ω)	(Ω)
C250-1000	250	10	1.00	3.00	40.0	0.30	0.80

Order Information

Packing

C250	1000	Model	Bag Q`ty
Product name	Hold Current	C250-1000	200
250V	mA		

Recognition: UL/ TÜV, pending.