

SEA&LAND ELECTRONIC CORP.

13F.,No.120-10,
 Sec.3,Zhongshan Rd.,Zhonghe City,Taipei County,
 Taiwan, R.O.C.
 Tel.: 886-2-8221-2567
 Fax.: 886-2-2225-7268

Techfuse
PTC Devices
 Resettable Fuse

PRODUCT: HPD600
 DOCUMENT: QR0429
 ECN. NO.:
 REV LETTER:
 REV DATE: 2010/7/1
 PAGE NO.: 1 of 1

Specification Sheet

Insulating Material:
 meets UL94 V-0 Requirements
 Lead-free, meets RoHS

Lead Material:
 Nickel
 0.11mm nominal thickness

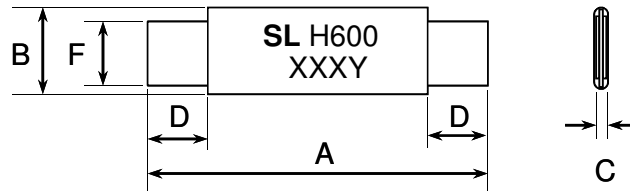

Marking:

Sea & Land Logo
SL H600 - Part identification
 XXXY - Lot identification

TABLE I. DIMENSIONS:

	A		B		C		D		F	
	MIN	MAX	MIN	MAX	MIN	MAX	MIN	MAX	MIN	MAX
mm	24.0	26.0	13.9	14.5	0.6	1.0	4.1	5.5	5.9	6.6
in	0.94	1.02	0.55	0.57	0.02	0.04	0.16	0.22	0.23	0.26

TABLE II. PERFORMANCE RATINGS:

Model	V_{max} (Vdc)	I_{max} (A)	I_{hold} @25°C (A)	I_{trip} @25°C (A)	P_d Typ. (W)	Maximum Time To Trip		Resistance		
						Current (A)	Time (Sec)	$R_{i_{min}}$ (Ω)	$R_{i_{max}}$ (Ω)	$R_{1_{max}}$ (Ω)
HPD600	20	100	6.00	11.7	2.8	30.00	5.0	0.007	0.014	0.019

Ordering Information

Packing

HPD	600	S	Bag Q'ty
Product name	Hold Current (A)	S= Single slitted lead Blank = Standard	HPD600 500 pieces / bag

Recognition: UL / TÜV , approved.



E201504/E319079 R-50004425